

Addenda

Bread Shelving Stick Base 30° Wedge Case For Use w/ SHSXX65A.7819

Structural Concepts®

DELIVERING FRESH. ALWAYS.™

• **SHSW3065A.7819**

(Lengths do not include the 7/8" end panel)

45-3/4"L x 35-3/4"D x 64-1/4"H

Included

- LED shelf lights



SHSW3065A.7819
Shown With Optional
Bumper, End Panel &
Product Retainer

| Specify | Standard Features | Additional Options |
|-------------------------------|---|---|
| EXTERIOR COLOR | • Laminated (Huntington Maple) | • Laminated (Portico Teak) |
| INTERIOR COLOR | • Painted (Caramel Sagawood), Textured | • Bronze Pearlescent |
| BASE | • Straight base | |
| BASE SUPPORT | • Levelers | |
| BUMPER | • Rail bumper on upper front panel | |
| BUMPER LEFT END | • None | • 1" bumper (black) • 1" bumper on end (#239 Storm Gray) |
| BUMPER RIGHT END | • None | • 1" bumper (black) • 1" bumper on end (#239 Storm Gray) |
| END PANEL LEFT | • None (specify per line-up) | • Cutaway end panel |
| END PANEL RIGHT | • None (specify per line-up) | • Cutaway end panel |
| UPPER REAR | • Solid upper back panel | |
| PRICE TAG MOLDING | • Price tag molding (silver) | |
| SHELF PRODUCT RETAINER | • None | • Side product retainers |
| SHELVING | • Metal shelves (4), lighted (LED) | |

| | | |
|--|---|----------------------------------|
| Intended Environment: Type I - Designed to operate in ambient conditions of 75°F with 55% relative humidity unless noted otherwise in system information below. | | |
| Zone | Intended Product To Be Displayed | Warmest Avg Prod Temp ° F |
| 1 | Packaged non-refrigerated products | Ambient |

PLAN VIEW

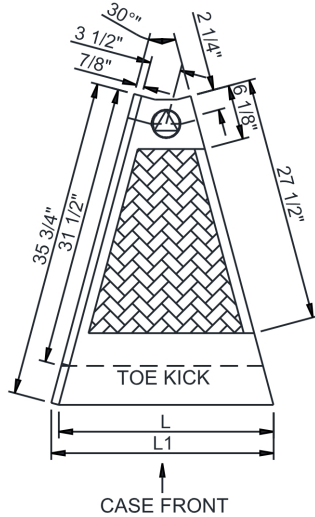

SIDE VIEW

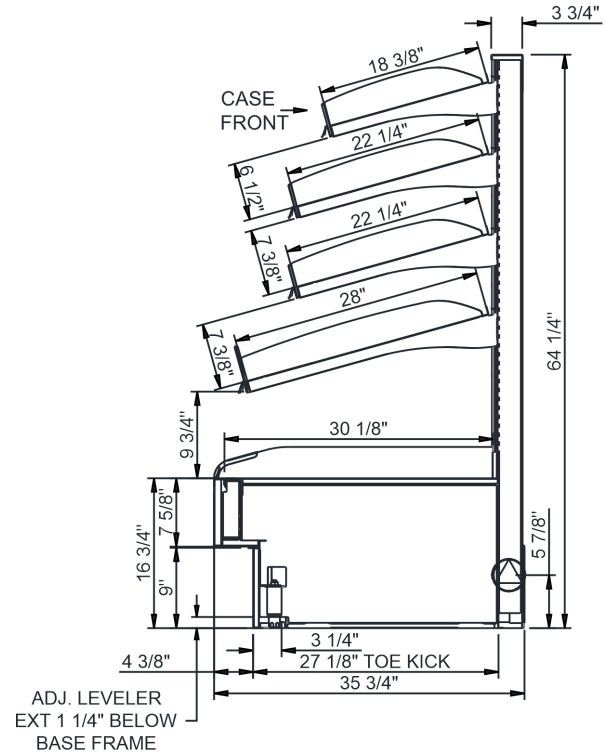

NOTE: ALL DIMENSIONS APPROXIMATE

- ELECTRICAL JUNCTION BOX**
(SUPPLIED WITH 6" LEADS OR POWER CORD).
- LOCATION OF DRAIN TUBE FOR REMOTE REF.**
ONLY (SUPPLIED WITH 3/4" OR 1 1/2" PVC TUBE).

- REFRIGERATION LINE CONNECTION.**
- REMOTE FLOOR SINK & UTILITIES**
ACCESS AREA.

- SELF-CONTAINED CASE SERVICE ACCESS AREA.**
- DRY CASE SERVICE ACCESS AREA.**

| Model Technical Specifications | | | | | | | | | | | | | | | | | | |
|--------------------------------|-------|-------|-----|----------------------|--|--|------------|---------|-------------|-------|-------|-----------|-----|--------------------|--------------------|-----------|-----|-----|
| Model | L" | L1" | L2" | System Circuit Volts | | | Phs | Freq | Amps *** | Watts | Wires | NEMA Plug | SST | Conv. Rack BTUH | Para. Rack BTUH | Est Wt | | |
| SHSW3065A.7819 | 24.00 | 45.75 | .00 | Ambient/Lights (N/A) | | | Circuit #1 | 110-120 | 1 | 60 | 0.70 | 8 | 2+G | Leads Single | N/A | N/A | N/A | N/A |

*** Does not include electric defrost on freezer models.

Regulatory Approvals:

| | |
|------------|---|
| All Models | ETL Listed to UL 65 ETL Sanitation to NSF/ANSI 2 |
|------------|---|



Important Notes:

- 1) 36" Minimum door entry clearance required (Without shipping skid).
- 2) Units are supplied with levelers which must be adjusted during installation to ensure the unit is level and plumb.

⚠ WARNING: This product can expose you to chemicals, including Urethane (Ethyl Carbamate), which are known to the State of California to cause cancer and birth defects or other reproductive harm. For more information go to www.P65Warnings.ca.gov.