

Front Facing - PC Non-Refrigerated Pastry Case

Models

PC4864.8008



Features	Standard	Options
EXTERIOR COLOR	<input type="checkbox"/> Laminated (Portico Teak)	<input type="checkbox"/> Laminated (Huntington Maple)
EXTRUSION COLOR	<input type="checkbox"/> Silver	<input type="checkbox"/> Black
INTERIOR COLOR	<input type="checkbox"/> Stainless steel	<input type="checkbox"/> Black
BASE	<input type="checkbox"/> Straight base w/ front storage & waste bin	
BUMPER	<input type="checkbox"/> 1" bumper	
DECK	<input type="checkbox"/> Corian solid surface (specify color)	
END PANELS	<input type="checkbox"/> Cutaway w/glass end panel	
FRONT DOORS	<input type="checkbox"/> Clear glass swinging doors (self-closing)	
LOWER REAR	<input type="checkbox"/> Open	
UPPER REAR	<input type="checkbox"/> Solid back panel, mirror	
PRICE TAG MOLDING	<input type="checkbox"/> Price tag molding	
SHELVING	<input type="checkbox"/> Tray support lighted shelves, (trays not included)	
LIGHTS	<input type="checkbox"/> LED 3500K w/ frosted lens	
ELECTRICAL CONNECT	<input type="checkbox"/> Leads	

Applications

- Upright self-service merchandiser for non-refrigerated pastry items

Front Facing PC Non-Refrigerated Pastry Case

Model	L x D x H (Lengths include end panels)
PC4864.8008	47-3/4"L x 28"D x 64"H

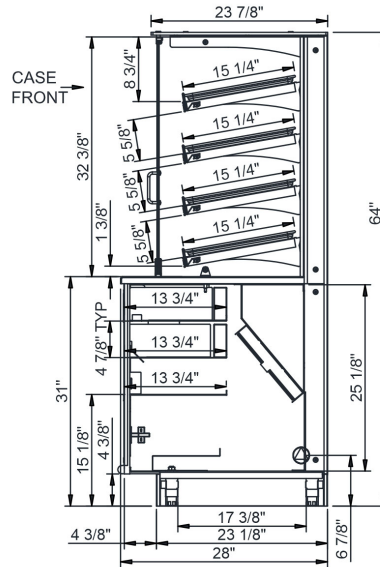

IMPORTANT NOTES:

- Units are supplied with levelers which must be adjusted during installation to ensure the unit is level and plumb.

WARNING

This product can expose you to chemicals including Urethane (Ethyl Carbamate), which are known to the State of California to cause cancer and birth defects or other reproductive harm. For more information go to www.P65Warnings.ca.gov.

INTENDED ENVIRONMENT

Designed to operate in ambient conditions of 75°F with 55% relative humidity.

WARMEST AVG PRODUCT TEMP

Zone	Temp (°F)
1	Ambient

INTENDED USE OF DISPLAY AREAS

Zone	Intended Use
1	Unpackaged non-refrigerated products

For more information on any of our products or services please visit us on the web at:

www.structuralconcepts.com

INFORMATION IS SUBJECT TO CHANGE WITHOUT NOTICE. Visit www.structuralconcepts.com for the most current specs.

Front Facing - PC Non-Refrigerated Pastry Case

DIMENSIONS / SHIPPING				
Model	L"	L1"	L2"	Est Wt (lbs)
PC4864.8008	N/A	47.750	0.000	N/A

ELECTRICAL																
Model	System Circuit Volts				Ph	Frq	Rated Load Amps	Min Cir Amps	Max OCP Amps	Watts	Wires	NEMA Plug	Amps Lights	Amps Fans	Amps Anti-Sweats	Amps Misc/Refrig/Heat
PC4864.8008	Ambient/Lights				1	60	1.01	15	15	44	2+G	Leads Multiple	0.70	0.31	N/A	N/A

REFRIGERATION														
Model	Zone	Section	System	Envt	REMOTE REFRIGERATION					GLYCOL / R744 REFRIGERATION				
					SST (°F)	Conv. Rack BTUH	Para. Rack BTUH	Defrost Interval (Hrs)	Defrost Duration (Mins)	Total GPM	Pressure Drop (psi)	Concent (%)	Liquid Temp (°F)	
PC4864.8008	All	Ambient	Ambient/Lights-N/A	Type I	N/A	N/A	N/A	N/A	N/A	N/A	N/A	N/A	N/A	N/A

INTENDED ENVIRONMENT
Type I - Designed to operate in ambient conditions of 75°F with 55% relative humidity unless noted otherwise under Envt above.

IMPORTANT NOTES
1) Units are supplied with levelers which must be adjusted during installation to ensure the unit is level and plumb.

WARMEST AVERAGE PRODUCT TEMP & INTENDED USE OF ZONES		
Zone	Temp (°F)	Intended Use
1	Ambient	Unpackaged non-refrigerated products

REGULATORY	
All Models	ETL Listed to UL 65 ETL Sanitation to NSF/ANSI 2



