

# Salad/Sandwich Prep - GP Combination Preparation Case - 8ft - Remote CO2 w/ Dixell Controller

## Models

GP835RRCLB.6527

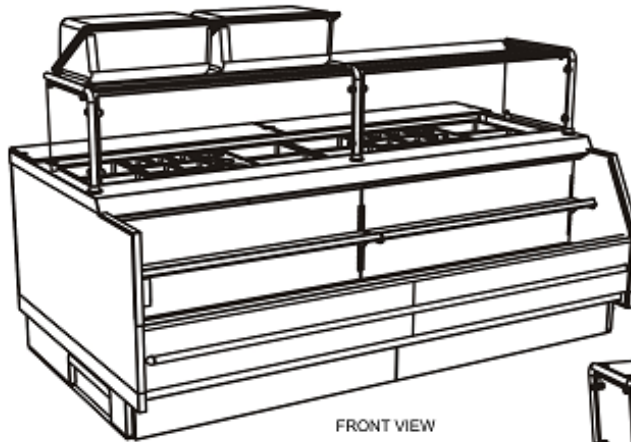

FRONT VIEW

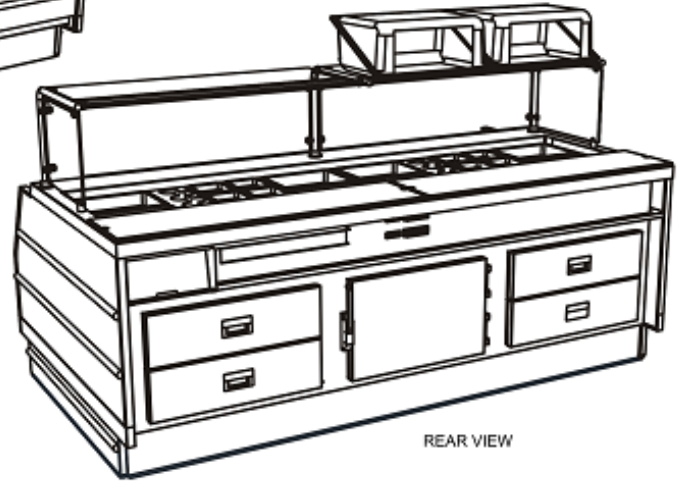

REAR VIEW

Features	Standard	Options
<b>EXTERIOR COLOR</b>	<input type="checkbox"/> Laminated (Xanadu)	
<b>INTERIOR COLOR</b>	<input type="checkbox"/> Stainless steel	
<b>BASE SUPPORT</b>	<input type="checkbox"/> Rail system for shims	
<b>BUMPER END</b>	<input type="checkbox"/> None	<input type="checkbox"/> 1" bumper (black) (3 rows)
<b>BUMPER FRONT</b>	<input type="checkbox"/> 1" bumper (black)	
<b>END PANELS</b>	<input type="checkbox"/> Full with mirror	
<b>LOWER FRONT PANEL</b>	<input type="checkbox"/> Publix matte black (4-3/8"D)	
<b>REAR STORAGE</b>	<input type="checkbox"/> Refrigerated rear storage w/drawers	
<b>REAR WORK SURFACE</b>	<input type="checkbox"/> White poly	
<b>BINS</b>	<input type="checkbox"/> Acrylic sub roll bin(s) w/o door(s)	
<b>LOWER DISPLAY</b>	<input type="checkbox"/> Solid shelf, non-lighted	
<b>PANS</b>	<input type="checkbox"/> Black pans, (8) 1/2 size, (8) 1/6 size, (6) 1/9 size, (6) Full size & (2) Dressing holders	
<b>SNEEZE GUARD</b>	<input type="checkbox"/> Clear sneeze guard glass w/ stainless steel posts	
<b>LIGHTS</b>	<input type="checkbox"/> LED sneeze guard, top & nose lights	
<b>ELECTRICAL CONNECT</b>	<input type="checkbox"/> Leads	
<b>REFRIGERATION</b>	<input type="checkbox"/> Remote CO2 refrigeration (specify type) w/ controller	

## Applications

- Combination Prep merchandiser for packaged / unpackaged refrigerated deli items.
- Models used in Prepared Foods & Salad/Sandwich Prep

# Salad/Sandwich Prep GP Combination Preparation Case - 8ft - Remote CO2 w/ Dixell Controller

Model	L x D x H (Lengths include end panels)
GP835RRCLB.6527	96"L x 54"D x 50-3/4"H

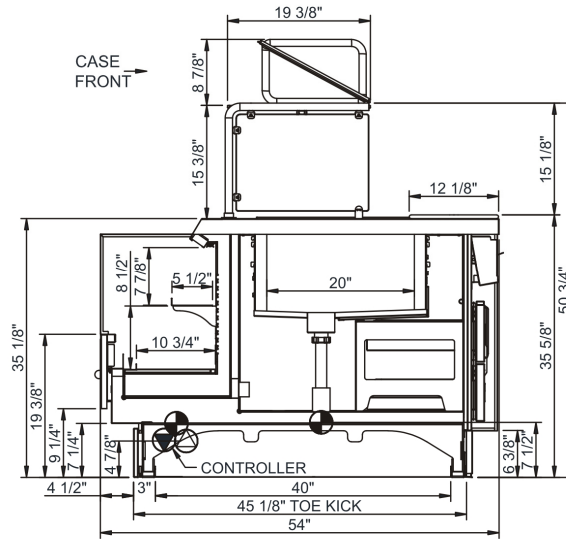

## IMPORTANT NOTES:

1) Units must be shimmed during installation to ensure unit is level and plumb.

## ⚠ WARNING

This product can expose you to chemicals including Urethane (Ethyl Carbamate), which are known to the State of California to cause cancer and birth defects or other reproductive harm. For more information go to [www.P65Warnings.ca.gov](http://www.P65Warnings.ca.gov).

## INTENDED ENVIRONMENT

Designed to operate in ambient conditions of 75°F with 55% relative humidity.

## WARMEST AVG PRODUCT TEMP

Zone	Temp (°F)
1	38

## INTENDED USE OF DISPLAY AREAS

Zone	Intended Use
1	Packaged / unpackaged refrigerated products