

# Front Facing - GHS 52"H Dry High-Capacity Service Case - BZP

## Models

GHSEH352D.7723



Features	Standard	Options
<b>EXTERIOR COLOR</b>	<input type="checkbox"/> Painted (Bronze Pearlescent)	
<b>INTERIOR COLOR</b>	<input type="checkbox"/> Stainless steel interior	
<b>TRIM COLOR</b>	<input type="checkbox"/> Silver	
<b>END PANELS</b>	<input type="checkbox"/> Full with mirror	
<b>FRONT GLASS</b>	<input type="checkbox"/> Flat angled single pane, lift-up	
<b>UPPER REAR DOORS</b>	<input type="checkbox"/> Reflective glass rear sliding doors	
<b>SHELVING</b>	<input type="checkbox"/> Tray support shelves (3 levels)	
<b>LIGHTS</b>	<input type="checkbox"/> LED top & shelf lights	
<b>ELECTRICAL CONNECT</b>	<input type="checkbox"/> Leads	
<b>MISCELLANEOUS</b>		<input type="checkbox"/> 1" bumper on upper front panel <input type="checkbox"/> Price tag molding for deck and shelving

## Applications

- High-capacity non-refrigerated service merchandiser for bakery items.

# Front Facing GHS 52"H Dry High-Capacity Service Case - BZP

Model	L x D x H (Lengths do not include 1" end panels)
GHSEH352D.7723	36-3/4"L x 43"D x 51-7/8"H

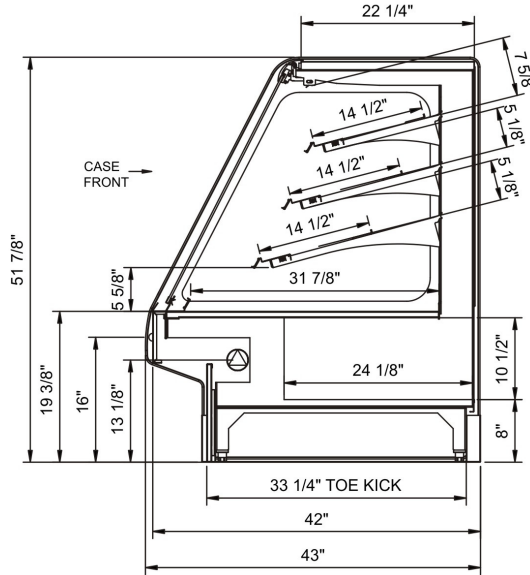

## IMPORTANT NOTES:

1) Units must be shimmed during installation to ensure the unit is level and plumb.



### WARNING:

This product can expose you to chemicals, including Urethane (Ethyl Carbamate), which are known to the state of California to cause cancer and birth defects or other reproductive harm. For more information go to [www.P65Warnings.ca.gov](http://www.P65Warnings.ca.gov).

## INTENDED ENVIRONMENT

Designed to operate in ambient conditions of 75°F with 55% relative humidity.

## WARMEST AVG PRODUCT TEMP

Zone	Temp (°F)
1	Ambient

## INTENDED USE OF DISPLAY AREAS

Zone	Intended Use
1	Unpackaged non-refrigerated products

For more information on any of our products or services please visit us on the web at:

[www.structuralconcepts.com](http://www.structuralconcepts.com)

INFORMATION IS SUBJECT TO CHANGE WITHOUT NOTICE. Visit [www.structuralconcepts.com](http://www.structuralconcepts.com) for the most current specs.



888 E. Porter Rd. Muskegon, MI 49441

231-798-8888

Revised 9/10/2019