

• **FSP4S-3R** 48-1/8"L x 43"D x 49-7/8"H



FSP4S-3R

- Included**
- (2) Refrigerated rear pull out drawers
 - Breeze self-contained refrigeration
 - E-Coated evaporator coil
 - Hydrocarbon refrigerant (R290)
 - One year parts & labor; 5 year compressor warranty
 - Rear wrapping board, white Sanalite®
 - Refrigerated rear storage w/ swing door and (2) drawers
 - Warmest average product temperature of 40°F or less

Specify	Standard Features	Additional Options
EXTERIOR COLOR	<ul style="list-style-type: none">• Laminate (stock colors)	<ul style="list-style-type: none">• Laminate (non-stock colors)• Powder coated (stock/non-stock colors)• Stainless steel
BASE SUPPORT	<ul style="list-style-type: none">• Casters (locking)	
COUNTERTOP SURFACE	<ul style="list-style-type: none">• Stainless steel	
REAR STORAGE	<ul style="list-style-type: none">• Refrigerated rear storage	
WORK SURFACE	<ul style="list-style-type: none">• White Sanalite®	
CONDIMENT PANS	<ul style="list-style-type: none">• Full size condiment pans - (3) 6"D prep pans, (2) 4"D rear drawer pans	
SNEEZE GUARD	<ul style="list-style-type: none">• Sneeze guard with stainless posts	
ELECTRICAL CONNECTION	<ul style="list-style-type: none">• 6' Straight blade power cord	
REFRIGERATION	<ul style="list-style-type: none">• Breeze self-contained refrigeration	

Std Notes: 1 - (1) 4"D pan per storage drawer

Grocerant

Refrigerated Service Food Bar Self-Contained 43"D

Structural Concepts®

DELIVERING FRESH. ALWAYS.™

Intended Environment: Type I - Designed to operate in ambient conditions of 75°F with 55% relative humidity unless noted otherwise in system information below.

Zone	Intended Product To Be Displayed	Warmest Avg Prod Temp ° F
1	Unpackaged refrigerated products-Prechilled to Warmest Avg Prod Temp.	40

PLAN VIEW

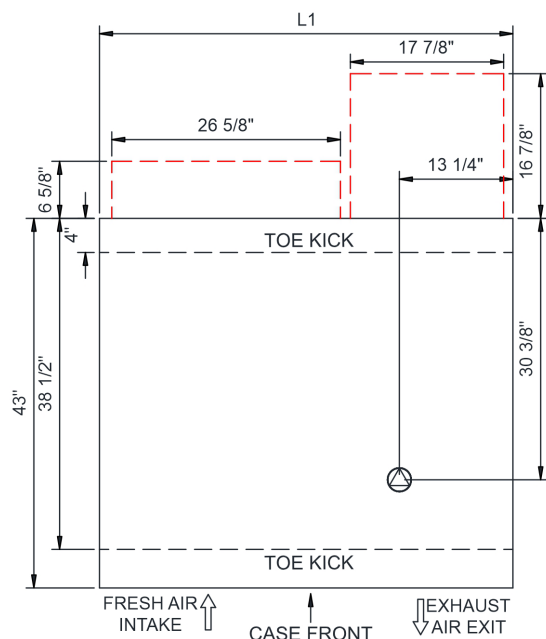

NOTE: SELF-CONTAINED ACCESS ONLY BY PULLING OUT CONDENSER

SIDE VIEW

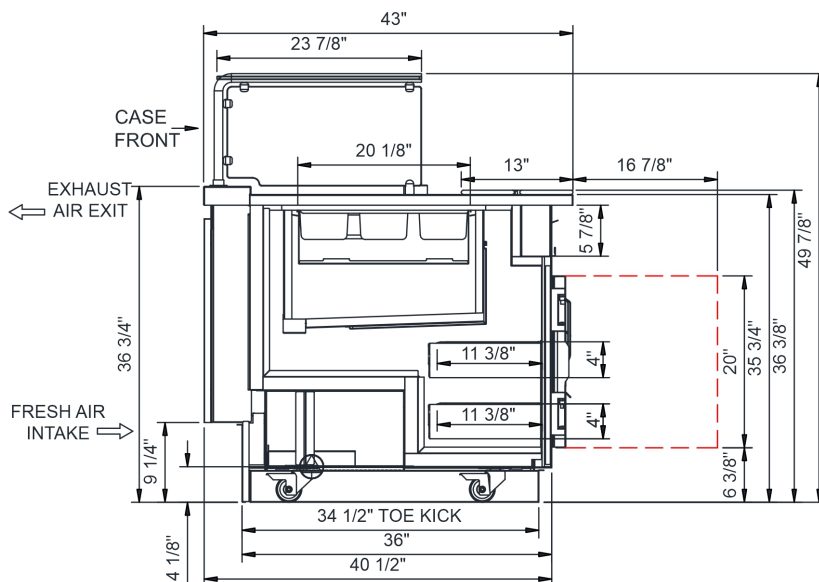

NOTE: ALL DIMENSIONS APPROXIMATE

- ELECTRICAL JUNCTION BOX (SUPPLIED WITH 6" LEADS OR POWER CORD).
- LOCATION OF DRAIN TUBE FOR REMOTE REF. ONLY (SUPPLIED WITH 3/4" OR 1 1/2" PVC TUBE).

- REFRIGERATION LINE CONNECTION.
- REMOTE FLOOR SINK & UTILITIES ACCESS AREA.

- SELF-CONTAINED CASE SERVICE ACCESS AREA.
- DRY CASE SERVICE ACCESS AREA.

Model Technical Specifications																
Model	L"	L1"	L2"	System Circuit Volts			Phs	Freq	Amps ***	Watts	Wires	NEMA Plug	SST	Conv. Rack BTU/H	Para. Rack BTU/H	Est Wt
FSP4S-3R	N/A	48.13	.00	Self-Contained (R290)	Circuit #1	110-120	1	60	14.83	1,548	2+G	5-20P	N/A	N/A	N/A	800

*** Does not include electric defrost on freezer models.

Regulatory Approvals:

All Models
Accordance with AHRI Std 1200
ETL Listed to UL 471
ETL Listed to CAN/CSA 22.2 No. 120
ETL Sanitation to NSF/ANSI 7



In Accordance with
AHRI Std 1200

DOE 2017
Energy Efficiency
Compliant

Important Notes:

- 1) Performance issues (product temperatures, water on floor, etc.) caused by adverse conditions are not covered by warranty.
- 2) Keep unit at least 15' from exterior doors, overhead HVAC vents, or any air curtain disruption.
- 3) Do not expose unit to direct sunlight or any heat source (ovens, fryers, etc.).
- 4) Compressor air lower front intake and upper front discharge. Front panel cannot be blocked.
- 5) If GFCI is required, a GFCI breaker MUST be used in lieu of a GFCI receptacle.

⚠ WARNING: This product can expose you to chemicals, including Urethane (Ethyl Carbamate), which are known to the State of California to cause cancer and birth defects or other reproductive harm. For more information go to www.P65Warnings.ca.gov.