

- **CB5082** 50-1/2"L x 43-5/8"D x 82-3/4"H
- **CB7282** 72"L x 43-5/8"D x 82-3/4"H



CB7282

Included

- CB5082 Supplied w/ (9) 16" x 12" x 4" & (3) 12" DIA x 20" wicker baskets
- CB7282 Supplied w/ (12) 16" X 12" X 4" & (4) 12" DIA X 20" wicker baskets
- Electrical leads
- LED 3500K w/ frosted lens
- Levelers
- One year parts & labor warranty
- Shelving removable and adjustable on 1" centers

| Specify | Standard Features | Additional Options |
|----------------|------------------------------------|--|
| EXTERIOR COLOR | • Laminate (stock colors) | • Laminate (non-stock colors) |
| INTERIOR COLOR | • Black | |
| BASE | • Straight base | |
| BUMPER FRONT | • 1" Boston bumper (specify color) | |
| END PANELS | • Cutaway end panel | |
| SHELVING | • (3) Lighted solid shelves | |
| MISCELLANEOUS | | • Second year parts & labor warranty |
| ACCESSORIES | | • Price tag molding (matches interior color) |

| | | |
|---|------------------------------------|---------------------------|
| Intended Environment: Type I - Designed to operate in ambient conditions of 75°F with 55% relative humidity unless noted otherwise in system information below. | | |
| Zone | Intended Product To Be Displayed | Warmest Avg Prod Temp ° F |
| 1 | Packaged non-refrigerated products | Ambient |

PLAN VIEW

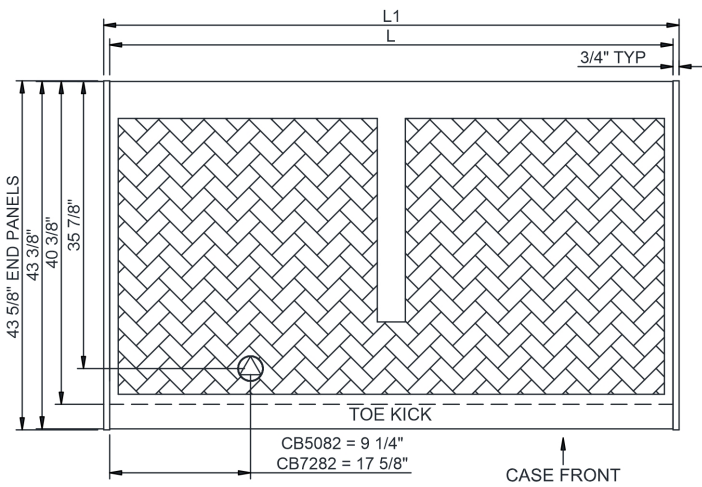

SIDE VIEW

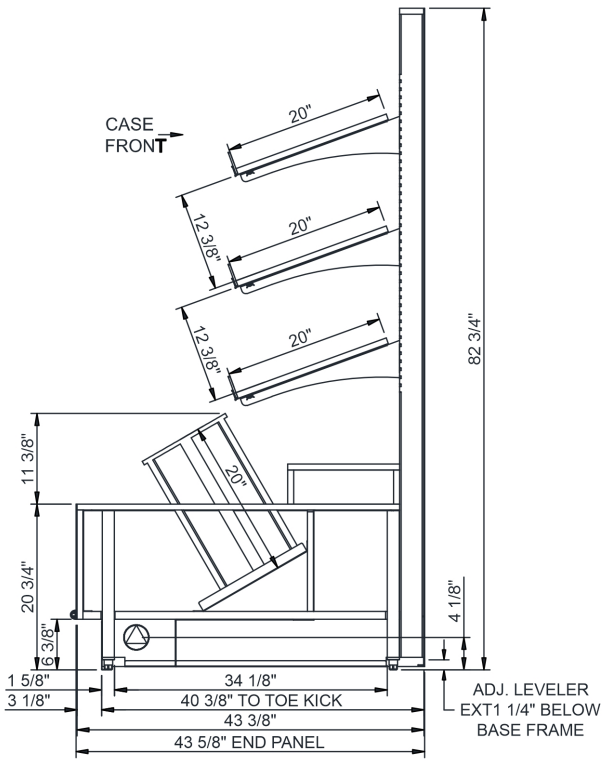

NOTE: ALL DIMENSIONS APPROXIMATE

- ELECTRICAL JUNCTION BOX (SUPPLIED WITH 6" LEADS OR POWER CORD).
- LOCATION OF DRAIN TUBE FOR REMOTE REF. ONLY (SUPPLIED WITH 3/4" OR 1 1/2" PVC TUBE).
- REFRIGERATION LINE CONNECTION.
- REMOTE FLOOR SINK & UTILITIES ACCESS AREA.
- SELF-CONTAINED CASE SERVICE ACCESS AREA.
- DRY CASE SERVICE ACCESS AREA.

| Model Technical Specifications | | | | | | | | | | | | | | | | |
|--------------------------------|-------|-------|-----|----------------------|------------|---------|-----|------|----------|-------|-------|--------------|-----|-----------------|-----------------|--------|
| Model | L" | L1" | L2" | System Circuit Volts | | | Phs | Freq | Amps *** | Watts | Wires | NEMA Plug | SST | Conv. Rack BTUH | Para. Rack BTUH | Est Wt |
| CB5082 | 49.00 | 50.50 | .00 | Ambient/Lights (N/A) | Circuit #1 | 110-120 | 1 | 60 | 0.70 | 19 | 2+G | Leads Single | N/A | N/A | N/A | 725 |
| CB7282 | 70.50 | 72.00 | .00 | Ambient/Lights (N/A) | Circuit #1 | 110-120 | 1 | 60 | 0.70 | 26 | 2+G | Leads Single | N/A | N/A | N/A | 975 |

*** Does not include electric defrost on freezer models.

Regulatory Approvals:

All ModelsETL Listed to UL 65

DOE 2017 Energy Efficiency Compliant

Important Notes:

1) Units are supplied with levelers which must be adjusted during installation to ensure the unit is level and plumb.

⚠ WARNING: This product can expose you to chemicals, including Urethane (Ethyl Carbamate), which are known to the State of California to cause cancer and birth defects or other reproductive harm. For more information go to www.P65Warnings.ca.gov.